

525 Parallel A Basket

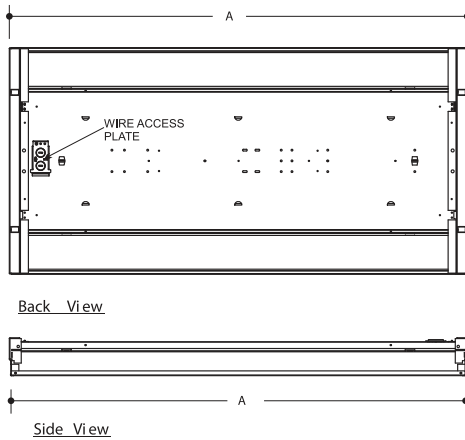

APPLICATIONS

Low-profile design makes it ideal for shallow or obstructed plenum applications.



MODEL	NOMINAL LENGTH	A
1x4	12"	47 3/4"
2x2	24"	23 3/4"
2x4	48"	47 3/4"

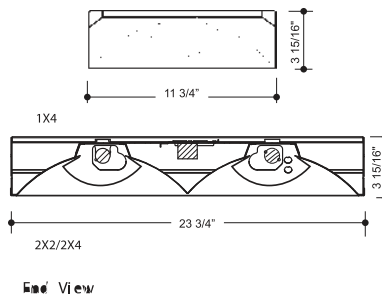

CONSTRUCTION

Die-formed and riveted, heavy-gauge steel housing assembly.

Precision-formed, steel reflector. Wiring access plate and knockouts are provided on back of housing.

MOUNTING

This fixture has been specifically designed for T-Bar applications.

Holes provided for chain-mounting support to building structure. Integral earthquake clips.

FINISH

White (matte), polyester powder painted visible surfaces.

ELECTRICAL

Rotary lampholders provided ensure positive lamp retention. All electrical components are CSA approved or UL listed. See product selection for optional ballasts. Sufficient knockouts are provided for connections and through wiring.

OPTIONS

Check product key or consult factory for available options.

525	-	PAB	-	1	-		-		-		-		=	Product Number
Series	Description	# of Lamps	Wattage	Size	Voltage	Options								
Recessed	Parallel A Basket	1	14w T5	2x2	120v	CO - Conv. Outlet								
			28w T5	1x4	347v	SW - Switch								
			28w T5	2x4	UNV									
			24 T5HO	2x2	UN4									
			54w T5HO	1x4										
			54w T5HO	2x4										
			17w T8	2x2										
			32w T8	1x4										
			32w T8	2x4										
			(Product Number eg.: 400-PV-214-T-277-R)											